

SW-STK-1P1D STICK ASSEMBLY INSTRUCTIONS

244 Bergen Boulevard, Woodland Park, NJ 07424, Phone 973.785.4347 - Fax: 973.785.4207

Patent No. 10,862,283

STEP 1:

Install the plastic raceway edges in the track base.

1. Install in the outer track as shown.
2. Have the plastic edge hang out one side by 3 or 4 inches.
3. Tap the edges in with rubber mallet or bottom of a rubber coated hammer handle.

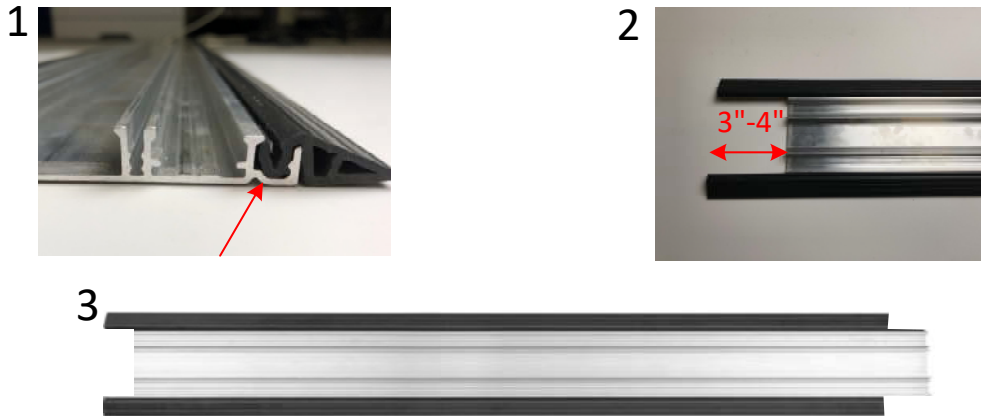

STEP 2:

Next, press the wired device box onto the extended plastic edging with the cord facing onto the track, then slide the device box tabs into the bottom slot on the track base only an inch or two.



STEP 3:

Run the power cord down the length of the raceway and out the end opposite the device box. Add any additional low voltage wires required by feeding them through the brush on the device box. Insert wiring clips as required (5 provided) to hold the wires in place.

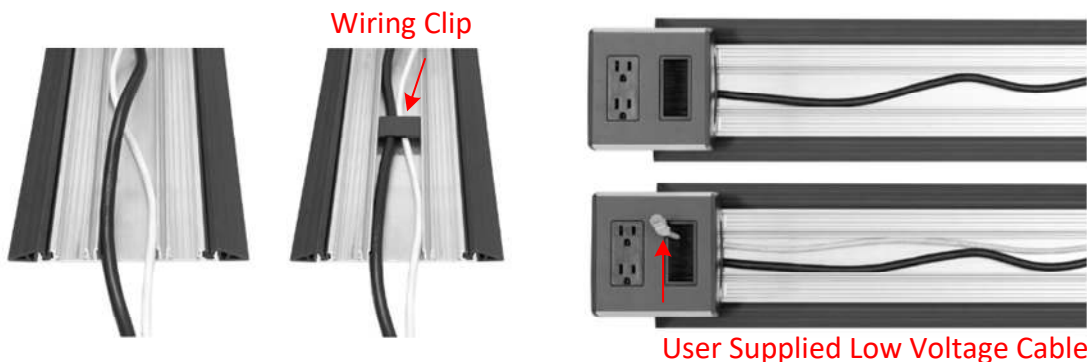

STEP 4:

Slide the tabs of the cable exit bracket into the bottom slot on the track base, opposite the device box, making sure all the wires that need to exit the track are passed through the bracket legs.



STEP 5:

Make sure the plastic edges are now back in place, pushed tight against the cable exit bracket. Next, install the cover on to the base starting with the cover abutting the cable exit bracket. Install the cover with a rubber mallet or bottom of a rubber coated hammer handle. Be sure to mount the cover touching the cable exit bracket.



STEP 6:

Slide the device box toward the cable exit bracket until it touches the installed cover. Force may be needed and a small amount of shaved plastic edging is normal, the box is intentionally tight to stop movement.

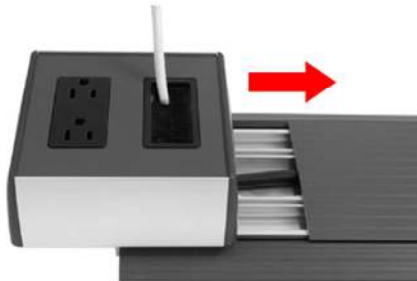

STEP 7:

Install the flat end plate onto the end of the track with the 2 supplied black Phillips-head screws to hold the device box in place.

